

# Ideas for including your company's **COMMITMENT** to mowomon LinkedIn

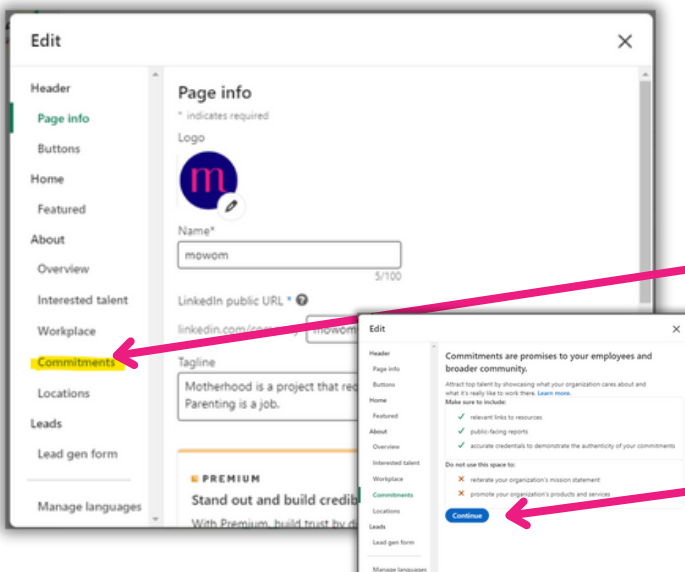

01

Go to your company profile on LinkedIn and click "**Edit Page**"

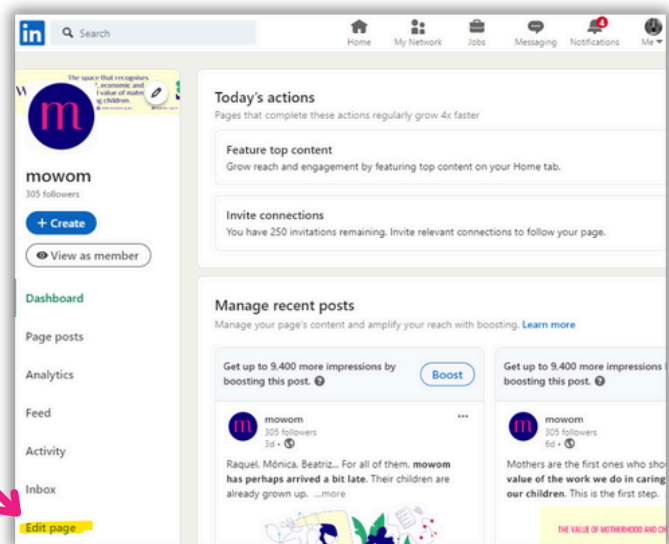

02

In the sidebar menu, look for the "**Commitments**" option and after the message select "**Continue**".



# 03

Now, choose the areas where you want to focus your commitment. There are **5 options**:

- Development and professional training
- Diversity, equality, and inclusion
- Sustainability
- Social impact
- Work-life balance

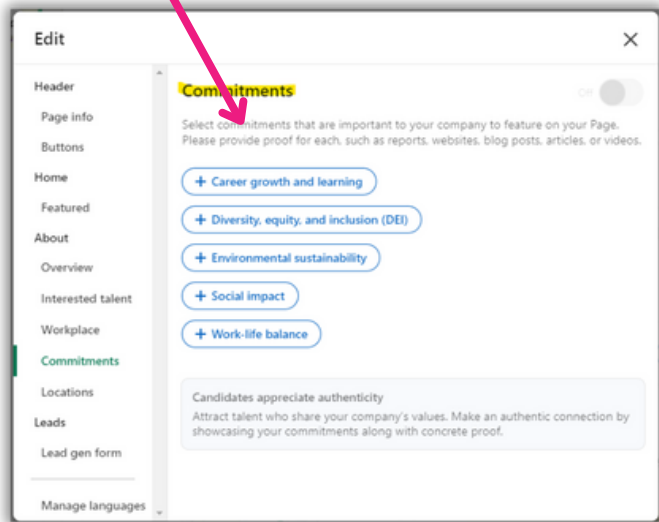

You can select one or more, depending on your company's focus!

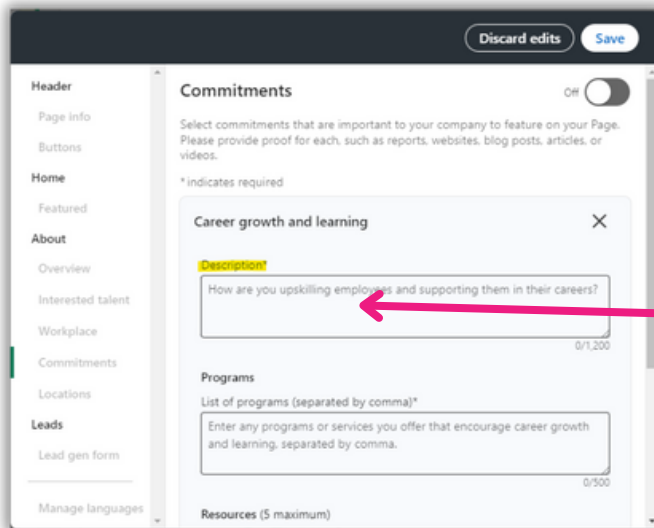

# 04

Now it's time to add a **description** of the commitment. Need ideas?

Check out the following example



## 1. Career growth and learning

We commit to offering training programs for women re-entering the job market after taking time for maternity. We provide education in both technical and soft skills, helping them update their knowledge and improve their employability.

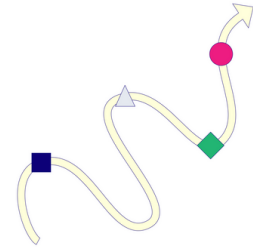

## 2. Diversity, equity, and inclusion

We commit to eliminating any bias in recruitment processes that penalizes women, particularly those with career breaks due to motherhood. We value the diversity of experiences and build more inclusive and equitable teams.

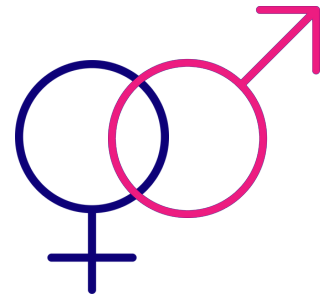

## 3. Sustainability

We promote social sustainability by supporting working parents and offering flexible work arrangements that allow them to balance their professional growth and family life in a responsible manner.



## 4. Social impact

We foster a workplace that supports mothers in their professional transition. We believe motherhood should be seen as a valuable contribution to both society and the workforce, and we commit to advocating for this vision.

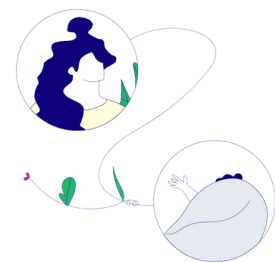

## 5. Work-life balance

We support work-life balance by offering working parents flexible hours, remote work options, and childcare days, ensuring they can continue advancing their careers without sacrificing their family role.

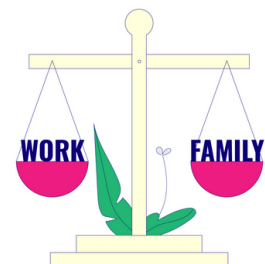

# 05

What specific **programmes or services** does your company offer?

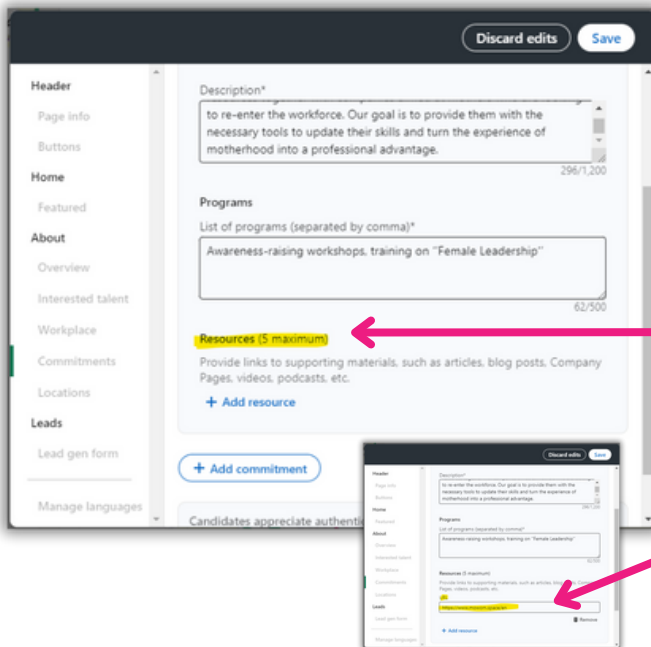
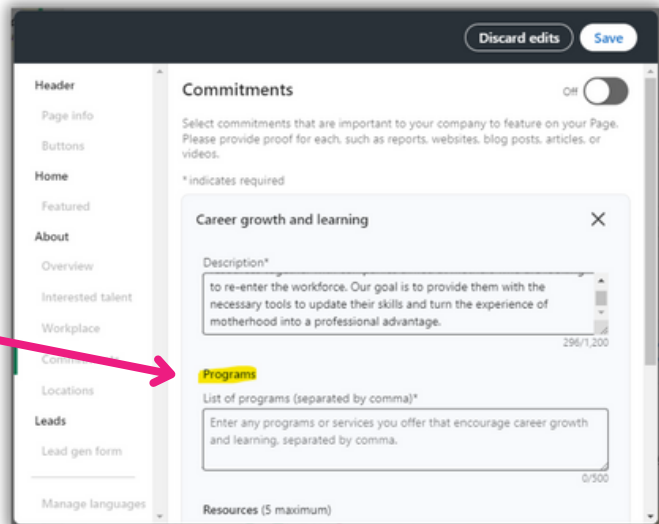

# 06

Now you can add various **resources** and examples. Take the opportunity and add the **mowom website** here.

# 07

Click "**Save**" to ensure your commitment is reflected on your profile. You're almost done!

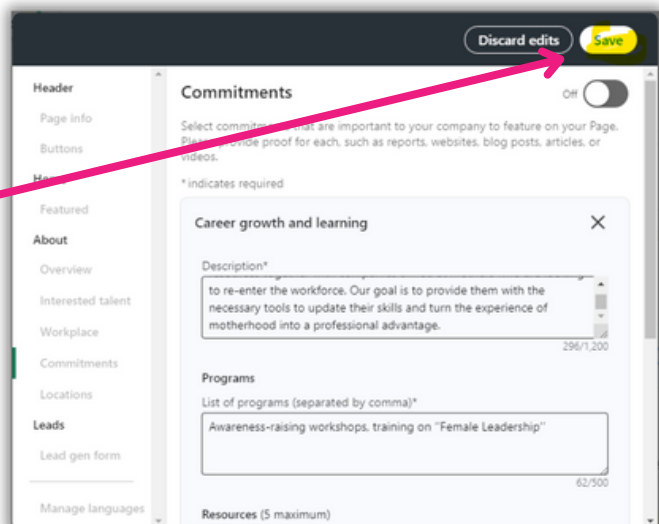

# 08

Don't forget to **activate** your commitment and **save** it again.

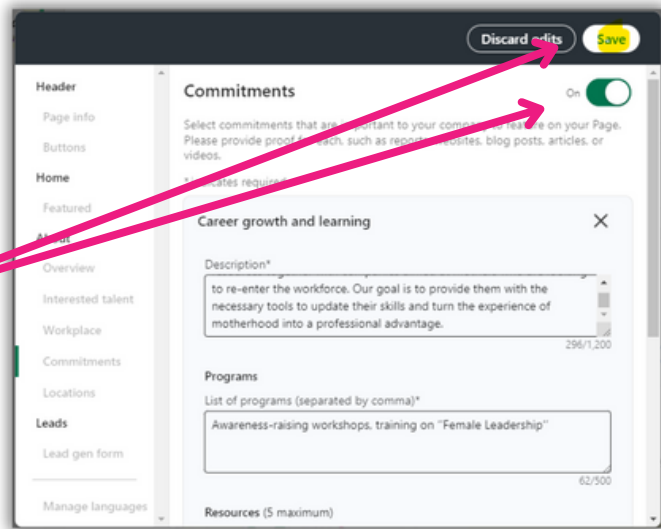

# 09

After saving, you will have the option to **publish a post** announcing your commitment to mowom.

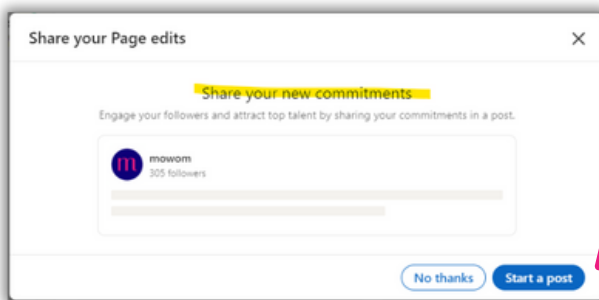

Here's an **example** you can use:

*"As part of our commitment to equality and inclusion, we have joined the mowom initiative. We believe in the value of parenting experiences and support policies that ease the return to work for mothers, recognizing their skills and contributions. Learn more about our commitment at ..."*



mowom

This is how it will look on your company page:

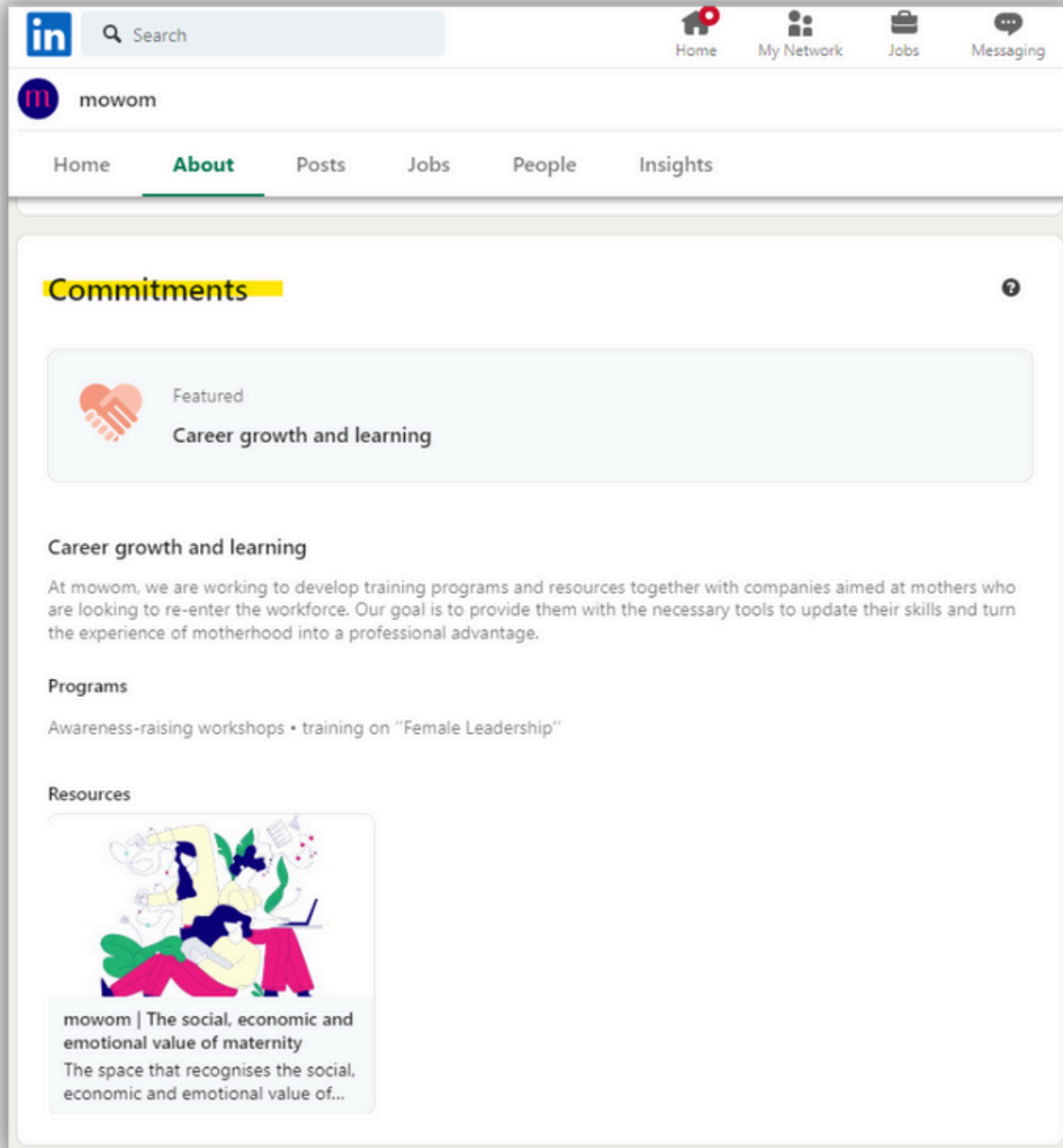

Join the movement!



#mowomcompany